

## WARRANTY:

Airmax® Ecosystems will repair or replace SilentAir™ SW Series compressors found to be defective within 2 years of the original purchase date. Air filter, flapper valves, and diaphragms are wearable items and are not covered by this warranty. This limited warranty is extended exclusively to the original purchaser beginning from the date of original receipt. Abuse or misuse of this product voids all warranty. In case of warranty claims, the product must be returned to place of purchase accompanied by original receipt.

## REPLACEMENT PARTS

SILENTAIR™ PUMP MODEL	REPLACEMENT DIAPHRAGM	REBUILD KIT*
SW-10	#120924	#120928
SW-20	#120925	#120929

\* Rebuild Kit includes diaphragm, flapper valve and filter.



## NOTE! Airline and Diffuser NOT Included!



Use with ProAir™-2 Diffuser (Item #510142) and EasySet™ Self Weighted Airline (Item #510218) for the best results.



**Airmax® Ecosystems**  
Natural. Clear Water. Guaranteed.™  
[www.airmaxeco.com](http://www.airmaxeco.com)



## SilentAir™ SW Series

Compressor for Shallow Water Aeration Systems

### Installation & Maintenance For Models:

- 10-SW (Item #120912)
- 20-SW (Item #120913)



**Airmax® Ecosystems**  
Natural. Clear Water. Guaranteed.™  
[www.airmaxeco.com](http://www.airmaxeco.com)

**2-YEAR WARRANTY**



# SilentAir™ SW Series

Compressor for Shallow Water Aeration Systems  
Installation & Maintenance Instructions

## WARNING

**ATTENTION:** Pour réduire le risque de choc électrique, débrancher la pompe avant de réparer cette pompe.

**AVERTISSEMENT:** Risch de choc électrique, cette pompe n'a pas été étudiée pour une utilisation dans les piscines. Cette pompe est fournie avec une prise de terre. Pour réduire le risque de choc électrique; se connecter uniquement à une prise correctement mise à la terre qui est desservie par un disjoncteur de fuite à la terre.

- Ne pas placer la pompe où elle pourrait tomber dans l'eau.
- Ne pas placer la pompe en plein soleil.
- Ne pas placer la pompe près de substances inflammables ou autres matières dangereuses ou des objets.
- Utiliser uniquement pour pompe à air.
- Placer horizontalement et s'assurer que la pompe est supérieure à la hauteur de la surface de l'eau pour empêcher l'eau de l'étang à siphonner.

**CAUTION:** To reduce the risk of electric shock, pull plug before servicing this pump.

**WARNING:** Risk of electrical shock, this pump has not been investigated for use in swimming pool areas. This pump is supplied with a grounded plug. To reduce the risk of electric shock: connect only to a properly grounded receptacle which is serviced by a Ground Fault Interrupter.

- Do not place pump where it might fall into water.
- Do not place pump in direct sunshine.
- Do not place pump near flammable or other dangerous materials or objects.
- Use only to pump air.
- Place horizontally and make sure pump is above the height of the water surface to prevent water siphoning out of pond.

## IMPORTANT SAFETY INSTRUCTIONS

WARNING - To guard against injury, basic safety precautions should be observed, including the following:

## READ AND FOLLOW ALL SAFETY INSTRUCTIONS

To avoid possible electric shock, special care should be taken since water is employed in the use of aquarium equipment. For each of the following situations, do not attempt repairs by yourself; return the appliance to an authorized service facility for service or discard the appliance:

1. If the appliance falls into the water, DON'T reach for it! First unplug it and then retrieve it. If electrical components of the appliance get wet, unplug the appliance immediately.
2. Carefully examine the appliance after installation. It should not be plugged in if there is water on parts not intended to be wet.
3. Do not operate any appliance plug or receptacle getting wet, position aquarium stand and tank to one side of a wall-mounted receptacle to prevent water from dripping onto the receptacle or plug. A "drip loop" should be arranged by the user for each cord connecting an aquarium appliance to a receptacle. The "drip loop" is that part of the cord below the level of the receptacle, or the connector if an extension cord is used, to prevent water traveling along the cord and coming in contact with the receptacle. If the plug or receptacle does get wet, DON'T unplug the cord. Disconnect the fuse or circuit breaker that supplies power to the appliance. Then, unplug and examine for presence of water in the receptacle.
- c. Close supervision is necessary when any appliance is used by or near children.
- d. To avoid injury, do not contact moving parts.
- e. Always unplug an appliance from an outlet when not in use, before putting on or taking off parts, and before cleaning. Never yank cord to pull plug from outlet. Grasp the plug and pull to disconnect.
- f. Do not use an appliance for other than intended use. The use of attachments not recommended or sold by the appliance manufacturer may cause an unsafe condition.
- g. Do not install or store the appliance where it will be exposed to the weather or to temperatures below freezing.
- h. If an extension cord is necessary, a cord with a proper rating should be used. A cord rated for less amperes or watts than the appliance rating may overheat. Care should be taken to arrange the cord so that it will not be tripped over or pulled.

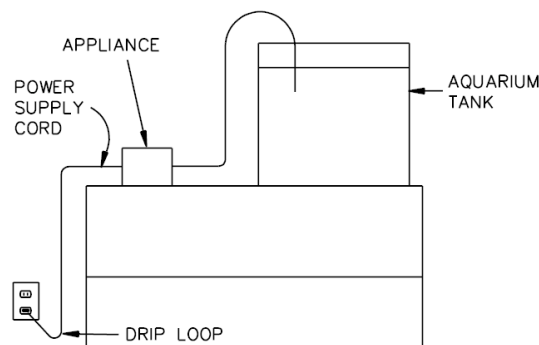

## SAVE THESE INSTRUCTIONS

## GROUNDING INSTRUCTIONS

This appliance should be grounded to minimize the possibility of electric shock. This appliance is equipped with an electric cord having an equipment grounding conductor and a grounding type plug. The plug must be plugged into an outlet that is installed and grounded in accordance with all appropriate codes and ordinances.

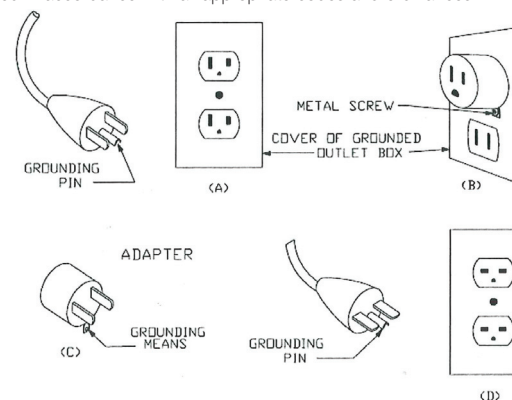

The appliance is for use on a nominal 120-volt circuit, and has a grounding plug that looks like the plug illustrated in (A) below. A temporary adapter which looks like the adapter illustrated in (B) and (C) below may be used to connect this plug to a two-pole receptacle as shown in (B) if a grounded outlet is not available. The temporary adapter should be used only until a grounded outlet can be installed by a qualified electrician. The green-colored rigid ear (lug, and the like) extending from the adapter must be fastened to a permanent ground such as a grounded outlet box.

IMPORTANT: Airmax® Ecosystems, Inc. is not responsible for losses, injury or death resulting from a failure to follow these safety precautions, misuse or abuse of equipment.

## TECHNICAL SPECS

MODEL	VOLTAGE	WATTAGE	MAX DIFFUSER WATER DEPTH	AIR FLOW
SW-10	120V / 60 Hz	50 Watts	Up to 6 Feet	2.5 CFM
SW-20	120V / 60 Hz	100 Watts	Up to 8 Feet	4.9 CFM

## INSTALLATION

Compressors should be installed 12 inches or more above the water level to ensure that water cannot flow from the airline/diffuser back to the pump. Compressors may be used without protection although for longer life it is suggested that it be placed indoors or under a protective ventilated cover. Keep pump as dry as possible. If left outdoors place it on a hard surface that will stay dry during heavy rains.

## MAINTENANCE & TROUBLESHOOTING

There are no parts that need lubrication. The integrated air filter requires periodic cleaning. To clean the filter media, remove the air filter cover. Extract the filter media from the pump and rinse thoroughly with cold water. Before replacing, wait for the air filter to dry. Replace media into the empty filter cavity, replace the air filter cover and refasten. When the airflow decreases, it is time to replace the diaphragms. There are two diaphragms, one at either end of the pump.

1. Disconnect the pump from the AC receptacle.
2. Remove the cover lid.
3. Unscrew the diaphragm assembly from either end of the pump.
4. Remove the diaphragm assembly.
5. Remove the black, round doughnut-like diaphragm and replace with the supplied parts.
6. Replace the diaphragm assembly and refasten.
7. Replace the cover lid.