

TH150 • TH250 • TH400 • TH750

EasyPro™ pond products

High Quality, Stainless Steel TH Series Submersible Pumps Instructions for Operation • Safety • Warranty

Thank you for purchasing the TH series waterfall pump. These stainless steel waterfall pumps are designed for continuous duty use. These pumps are a great choice for waterfalls, pond fountains and similar applications. The compact design makes them great for skimmers. The pumps are built with overload protections, thermal overload protection and auto reset. The pumps come standard with a 2" NPT outlet.

Safety & Electrical Connections

1. Always disconnect the electricity supply before handling, maintaining, repairing or installing any pond equipment.
2. Always make sure you know the correct amps and voltage required before installing.
3. EP waterfall pumps come in both 115 volt and 230 volt.
4. Always connect to a Ground Fault Circuit (GFCI).
5. Never let the pump run without water as this will damage the impeller, over heat the pumps and possibly burn out the pump.
6. Do not use this product in bathrooms or swimming pools.
7. Do not let the water level in your water feature fall below the top of the pump body.
8. All electrical work must be performed by a qualified technician. Always follow the National Electrical Code (NEC) or the Canadian Electrical Code as well as all local, state and provincial codes. Code questions should be directed to your local electrical inspector. Failure to follow electrical codes and OSHA safety standards may result in personal injury or equipment damage. Failure to follow manufacturer's installation instructions may result in electrical shock, fire hazard, personal injury or death, damaged equipment, provide unsatisfactory performance and may void manufacturer's warranty.
9. Always operate the pump in a skimmer or a submersible pump screen.



C 230459 US

10. When storing the pump for an extended period of time, wash it and store indoors in a bucket of water.
11. Always use a check valve on the pumps.
12. Do not attempt to disassemble pump during the warranty period. If there are any questions please contact you local dealer.

Service & Maintenance

1. Disconnect all power supplies before service.
2. The pump should be removed from the pond on a regular basis, cleaned and checked over for damage to prolong the life of the pump.
3. Clean the impeller and intake screen when the flow is visibly reduced.
4. Clean the pump and impeller with clean fresh water.
5. Check inside the impeller housing for large debris or algae, which could reduce the flow.
6. Clean the impeller housing with a damp cloth. Clean the outside of the impeller with a damp cloth and clean water.
7. Check and tighten nuts and bolts if required.

Specifications

Model	HP	Volts	Amps	Weight
TH150	1/4	115	2.9	15 lbs.
TH1502	1/4	230	1.5	15 lbs.
TH250	1/3	115	4.0	15 lbs.
TH2502	1/3	230	2.0	15 lbs.
TH400	1/2	115	5.6	20 lbs.
TH4002	1/2	230	2.8	20 lbs.
TH750	1	115	9.5	27 lbs.
TH7502	1	230	4.8	27 lbs.

Pump Performance Chart

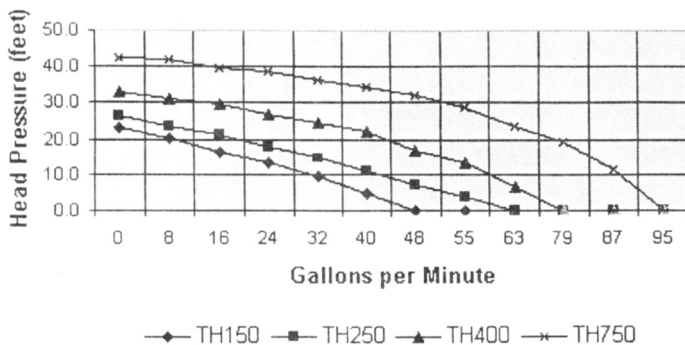

Replacement Parts for TH Pumps

Part	TH150	TH250	TH400	TH750
Capacitor	TH150CAP	TH250CAP	TH400CAP	TH750CAP
Impeller	TH150i	TH250i	TH400i	TH750i
Handle	TH4	TH4	TH4	TH4
Rubber Feet	THRF	THRF	THRF	THRF
Mechanical Seal Set	THMECSEAL	THMECSEAL	THMECSEAL	THMECSEAL
Cord	THCORD	THCORD	THCORD	THCORD2
Bearing Set (top & bottom)	THBS1	THBS1	THBS2	THBS2
Bottom Seal	THBS	THBS	THBS	THBS
Offset Flange	THF	THF	THF	THF

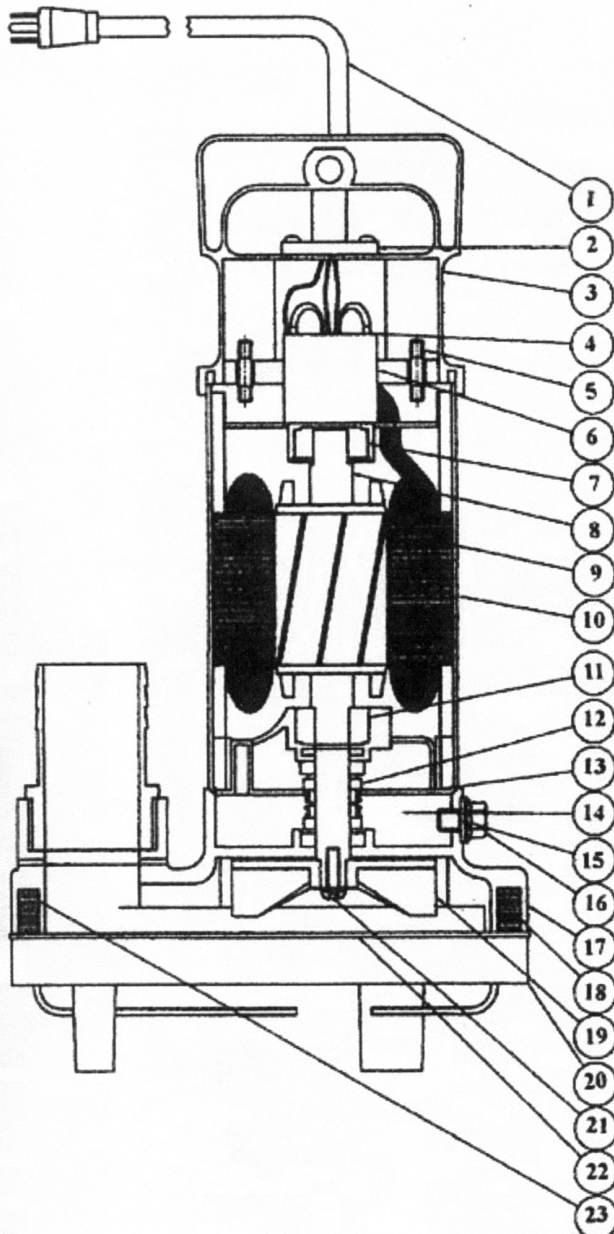

No.	Parts Name
1.	Power Cord
2.	Screw Washer
3.	Handler
4.	Capacitor
5.	Double Tapping Screw
6.	Packing
7.	Bearing
8.	Motor Shaft
9.	Motor
10.	Motor Casing
11.	Bearing
12.	Mechanical Seal
13.	Packing
14.	Seal Oil Chamber
15.	Packing
16.	Screw
17.	Pump Cover
18.	Screw
19.	Impeller
20.	Pump Base
21.	Impeller Screw
22.	Packing
23.	Flow Out Pipe

Warranty:

- This product is warranted against any mechanical or material defects for a period of two years from the date of purchase (impellers are a wear item and are not covered by warranty).
- This warranty does not cover accidental damage to the product due to abuse or negligence by the consumer.
- An RMA number must be obtained by calling EasyPro Pond Products at 800-448-3873 and be included on package before returning for warranty issues. Return warranty items to: EasyPro Pond Products, 4385 East 110th, Grant, MI 49327. Be sure to include RMA number, original receipt, name, return address and phone number in package.
- In the event of a warranty claim, please return the pump postage prepaid with the original receipt for repair or exchange. No warranty claims will be honored without the original receipt.
- The manufacturer or supplier shall not be held liable for any damages caused by defective components or materials of this pump; or for loss incurred because of the interruption of service; or any consequential/incidental damages and expenses arising from the production, sale, use or misuse of this product.
- The manufacturer or supplier shall not be held liable for any loss of fish, plants or any other livestock as a result of any failure or defect of this product.
- If you experience a failure of your pump, please check the following before returning to us:
 1. Remove filter housing, clean and inspect impeller and surrounding chamber, reassemble and test pump;
 2. Verify electrical supply.

Return
warranty
pumps to:

EasyPro
Pond Products
4385 East 110th
Grant, MI 49327

Be sure to include
RMA number, original
receipt, return
address and phone
number in package!

Each year we receive numerous pumps back that simply have a small stone lodged in the impeller, are plugged from lack of cleaning or do not work due to low voltage caused by an overloaded circuit. These are not warranty items. Please take the time to verify your problem is actually a defective pump before returning. EasyPro will pay postage to return pump to you provided it is a warranty issue. If you send a pump in for warranty and it checks out fine — you will also be responsible for the cost of return postage.



800-448-3873 • Grant, Michigan
www.EasyProPondProducts.com • info@EasyProPondProducts.com